

DIADEM-150

SLOPED / RDTS EAVES PROFILE

#901320_F150_01



Detail Drawing

■ Green up the roof!

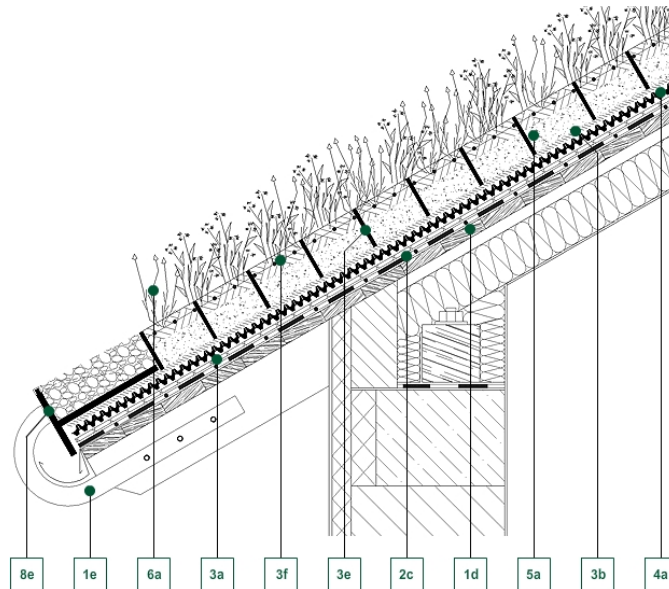

Decking constructions:

- 1d - Measured planking on trussing
- 1e - Gutter-supporting piping

Geotextile layers:

- 3a - VLU-300 mechanical protecting layer
- 3b - VLF-150 filter layer
- 3e - Diadomino
- 3f - JGW-500 jute net

Drainboards:

- 4a - DD-25H drainage board

Growth medias:

- 5a - SEM-12 extensive growth medium

Vegetation:

- 6a - Drought-resistant perennials

Edging element:

- 8e - RDL edging
- This product is not available in your region.

Description of section:

In the case of sloping roof structures between 10 and 20 degree incline, the use of Diadrain-25 in conjunction with JWG-500 jute netting provides sufficient erosion protection, however careful consideration should still be given to the roof edge finish. All sloping roofs require the careful choice of growing medium and vegetation and expert advice should be sought. In the case of steeper than 20 degrees of roof designs it is essential that a permanent soil erosion prevention layer is installed. This layer should act independently of the waterproofing membrane to avoid the transfer of unwanted forces. The roof edge finish has to be designed to withstand the downward forces present. The use of the RDTS eaves profile engineered to satisfy this requirement.

DIADEM USA, Inc.

721 NW Ninth Avenue, Suite 400, Portland, OR-97209
E-mail: info@diademusa.com, Web: www.diademusa.com