

DIADEM-350

OUTLET TERRACE / KSR MAINTENANCE BOX

#901333_H350_01



Detail Drawing

■ Green up the roof!

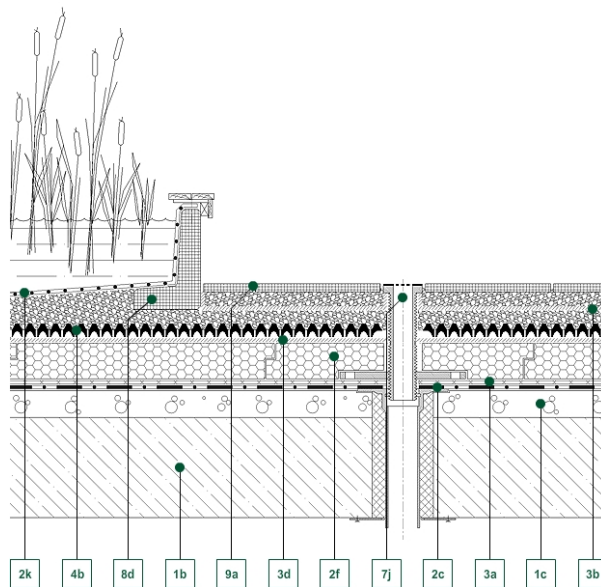

Decking constructions:

- 1b - Reinforced concrete structure
- 1c - Slope-forming layer

Water isolation:

- 2c - Waterproof membrane
- 2f - Extruded PS-foam thermal insulation

Geotextile layers:

- 3a - VLU-300 mechanical protecting layer
- 3b - VLF-150 filter layer
- 3d - VLR-130 separating filter layer

Drainboards:

- 4b - DD-40H Retention Board

Hydrotechnical products:

- 7j - BLH-30 terrace outlet

Terraces accessories:

- 9a - FK-5 Slab spacer

Description of section:

It is possible to create a simple pond construction on the roof using the BW concrete edge pieces to form the perimeter. This structure would then be lined with a sandwich construction formed of an underlayer of VLU-300 Protective Fleece, pond liner and a further upper layer of VLU-300 Protective Fleece. It is important that the pond liner is not used as the primary waterproofing layer. Dual drainage can be achieved by means of the BLH Terrace Outlet. An important feature of this product is that it can be adjusted between 60 and 300 mm, giving greater freedom in the design of the terrace build up.

DIADEM USA, Inc.

8795 SW Tualatin Sherwood Rd #1005, Tualatin, OR 97062
E-mail: info@diademusa.com, Web: www.diademusa.com