

# DIADEM-150

OUTLET / KSR MAINTENANCE BOX KLS

#901311\_D150\_01



## Detail Drawing

■ Green up the roof!

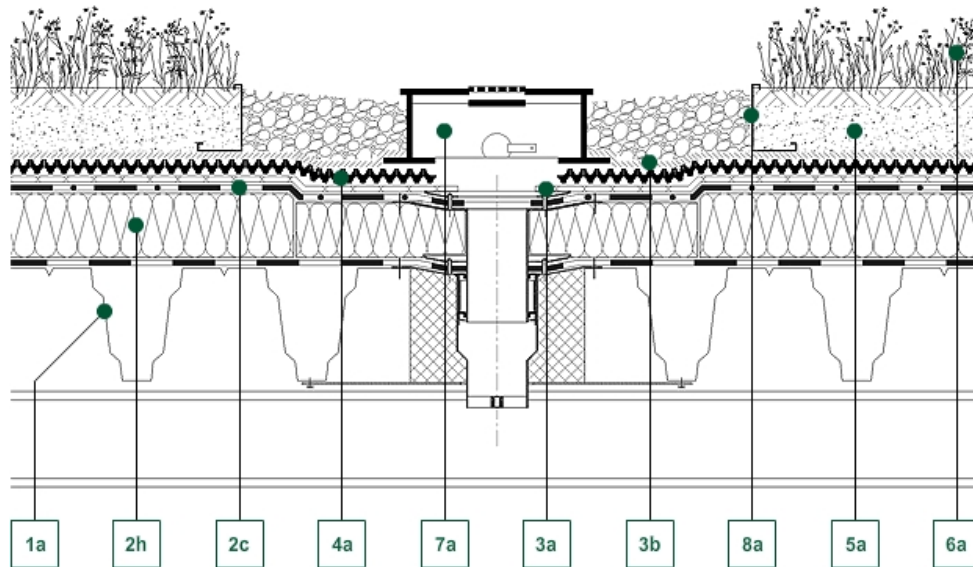

### Decking constructions:

1a - Steel trapezoid sheet structure

### Water isolation:

2c - Waterproof membrane

2h - Thermal insulation

### Geotextile layers:

3a - VLU-300 mechanical protecting layer

3b - VLF-150 filter layer

### Drainboards:

4a - DD-25H drainage board

### Growth medias:

5a - SEM-12 extensive growth medium

### Vegetation:

6a - Drought-resistant perennials

### Hydrotechnical products:

7a - KSR-10 Greenroof outlet box

### Edging element:

8a - KLS-AL-8/12 Gravel Board

### Description of section:

Good practice requires that rainwater outlets are designed to remain free from obstructions, for example gravel or vegetation. These outlets should be accessible at all times. A footwide gravel border should be installed around all roof penetrations to the thickness of the growing medium. Separation of the materials is achieved by means of a gravel board such as KLS. This board also allows rainwater to drain easily to the outlets.

DIADEM USA, Inc.

8795 SW Tualatin Sherwood Rd #1005, Tualatin, OR 97062  
E-mail: [info@diademusa.com](mailto:info@diademusa.com), Web: [www.diademusa.com](http://www.diademusa.com)